

**PHASE I ENVIRONMENTAL SITE ASSESSMENT**

**Southeast Corner of Prairie Street & Corbin Avenue  
Northridge, California**

**AES Project No. 96-214**

**October 7, 1996**

*Submitted To:*

**THE KRAUSZ COMPANIES, INC.  
651 Gateway Boulevard, Suite 1010  
South San Francisco, California 94080**

*Prepared By:*

**AMERICAN ENVIRONMENTAL SPECIALISTS, INC.  
7400 Center Avenue, Suite 113  
Huntington Beach, California 92647  
(714) 379-3333**

**PREPARED BY:**

Handwritten signature of Kristen Williamson in cursive script, written over a horizontal line.

Kristen Williamson, Registered Environmental Assessor

**REVIEWED BY:**

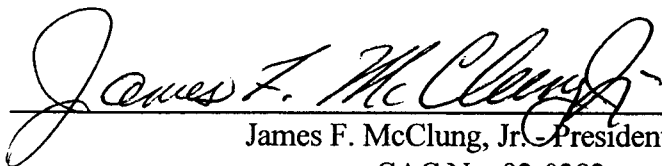
Handwritten signature of James F. McClung, Jr. in cursive script, written over a horizontal line.

James F. McClung, Jr. President AES

CAC No. 92-0382

REA No. 05032

## EXECUTIVE SUMMARY

American Environmental Specialists, Inc. (AES) has completed a Phase I Environmental Site Assessment of the property located at the southeast corner of Prairie Street and Corbin Avenue in Northridge, California. The objective of the Phase I Environmental Assessment was to provide The Krausz Companies, Inc. with information regarding potential areas of environmental concern that may be associated with past and/or current land use, both on and in the vicinity of the Site. A summary of the assessment and our findings is summarized below.

### **I. Property Use**

An orchard occupies approximately the western two-thirds of the property, and an asphalt-paved parking lot occupies the eastern third. The property was used for agriculture since 1919. In the mid 1960s, the eastern third was converted to a parking area to service the adjacent Litton Guidance and Control facility.

### **II. Scope of Investigations**

The information presented in this report is based on the following:

- Site reconnaissance conducted on September 6, 1996 to identify and assess areas of potential environmental concern on the subject property;
- Survey of the site vicinity to identify and assess potential environmental concerns, which could impact the property;
- A site history review which consisted of a review of building permits, US Geological Survey (USGS) topographic maps, aerial photographs, and other available documents to assess past land usage as it relates to the environmental condition of the property;
- A review of public records to identify sites of environmental concern on or within a radius of the property as determined by ASTM. ; and
- Review of documents provided by Teledyne and Litton regarding previous environmental assessments and permit information pertaining to the Site.

Sampling for lead in water, lead paint, asbestos, and radon was not included in the scope of this assessment.

### **III. Environmental Issues**

AES did not identify issues of environmental concern during this assessment. Based on the results of this assessment, AES does not recommend further assessment of the Site at this time.

## TABLE OF CONTENTS

1.0 SUBJECT SITE .....	1
1.1 Site Description.....	1
1.1.1 Site Location/Identification.....	1
1.1.2 Gross Site Area.....	1
1.1.3 Site Development .....	1
1.1.4 Building Description .....	1
1.1.5 Source of Potable Water.....	1
1.1.6 Sewage Disposal System.....	2
1.1.7 Solid Waste Disposal.....	2
1.1.8 Source of fuel for heating and cooling.....	2
1.1.9 Other Improvements.....	2
1.2 Property Use.....	2
1.2.1 Former Property Use .....	2
1.2.1.1 Chronology .....	2
1.2.1.2 Sources.....	2
1.2.2 Current Property Use.....	3
1.2.3 Current and Historical Regulatory Review for the Subject Site.....	3
1.2.4 Review of Title Documents.....	3
1.3 Geology .....	3
1.4 Hydrology.....	4
1.5 Non-CERCLA Issues.....	4
1.5.1 Asbestos.....	4
1.5.2 Lead Paint.....	4
1.5.3 Lead in Drinking Water.....	4
1.5.4 Radon.....	4
1.5.5 PCBs .....	4
1.6 Other .....	4
1.7 Environmental Issues.....	4

2.0 SURROUNDING PROPERTIES .....	5
2.1 Description.....	5
2.1.1 Historical Use .....	5
2.1.2 Current Use.....	5
2.2 Regulatory Review.....	5
3.0 ANALYSIS AND CONCLUSIONS.....	7
3.1 Subject Site.....	7
3.2 Off-Site.....	7
4.0 LIMITATIONS .....	8
5.0 STATEMENT OF INDEPENDENCE.....	9

APPENDICES

Appendix “A” Maps and Figures .....	10
A.1 Property Vicinity Map	
A.2 Current USGS 7.5 Minute Topographical Map	
A.3 Site Plan	
Appendix “B” References.....	11
Appendix “C” Other Reports .....	13

## PHASE I ENVIRONMENTAL SITE ASSESSMENT

19601 Nordhoff Street  
Northridge, California

### 1.0 SUBJECT SITE

This report presents the results of a Phase I Environmental Site Assessment conducted for the subject property (the site) in September 1996. The objective of the Phase I Environmental Assessment was to provide The Krausz Companies, Inc. with information regarding potential areas of environmental concern that may be associated with past and/or current land use, both on and in the vicinity of the Site. The assessment was performed by Ms. Kristen Williamson, an associate at American Environmental Specialists, Inc. (AES) on September 6, 1996.

### 1.1 Site Description

#### 1.1.1 Site Location./Identification

The site is located at the southeast corner of Prairie Street and Corbin Avenue in Northridge, California and consists of the northwest portion of the parcel identified by APN 2761-035-008. Northridge is an unincorporated area of Los Angeles County. According to the City of Los Angeles Planning and Zoning Department, the Site is designated MR2-1 for manufacturing and residential development not to exceed 3 stories. Figure 1 shows the Site location.

#### 1.1.2 Gross Site Area

The site is a rectangular parcel totaling approximately 8 acres.

#### 1.1.3 Site Development

An orchard covers approximately the western two-thirds of the property, and the eastern third is used as an asphalt parking lot.

#### 1.1.4 Building Description

There are currently no buildings on the site, with the exception of a small guardhouse.

#### 1.1.5 Source of Potable Water

Currently there is no potable water at the site.

### 1.1.6 Sewage Disposal System

There is not an existing sewer connection at the site.

### 1.1.7 Solid Waste Disposal

Solid waste is not currently generated at the site.

### 1.1.8 Source of Fuel for Heating and Cooling

There is not a current source of fuel at the site.

### 1.1.9 Other Improvements

Other improvements were not observed during the site reconnaissance.

## 1.2 Property Use

### 1.2.1 Former Property Use

According to a review of aerial photographs, the property has been used for agriculture since 1919. By 1968, the eastern portion of the property was converted to a parking lot to service the adjacent Litton Guidance and Control facility.

#### 1.2.1.1 Chronology

- 1940 The site was used for agriculture
- 1950 The site was used for agriculture
- 1960 The site was used for agriculture
- 1968 The eastern third of the property was used as a parking area.
- 1970 The site was developed in its current configuration.
- 1980 The site was developed in its current configuration.
- 1985 The site was developed in its current configuration.
- 1990 The site was developed in its current configuration.
- 1996 The site was developed in its current configuration.

#### 1.2.1.2 Sources

The Site history is based on the City of Los Angeles Building Permits for the adjacent Litton facility, the USGS topographic map, Canoga Park Quadrangle, review of aerial photographs at California State University Northridge's (CSUN) Map Library, and an

interview with Mr. Ray Cargill, the operations manager at the Litton facility since 1968. Sanborn Fire Insurance Maps were requested, but coverage is not available for the site. A summary of the information available from each source is provided below.

Fire Department:	The Los Angeles Fire Department has no records of a UST at the site
Building Permits:	Permit documents were available from 1966 – present, and indicate that construction of the Litton facility began in 1966 and was completed in 1968.
USGS Topographic Map:	The Site was an orchard in 1952 and is shown in its current configuration in 1967.
Aerial Photographs:	In 1989 and 1975, the site is shown in its current configuration. In 1952, 1938, and 1919, the site used for agriculture.

#### 1.2.2 Current Property Use

An orchard occupies the western two-thirds of the property, and an asphalt parking lot occupies the eastern third.

#### 1.2.3 Current and Historical Regulatory Review for the Subject Site

AES retained Environmental Risk Information & Imaging Services (ERIIS) to perform an environmental database search for facilities identified as hazardous substance and/or hazardous waste sites on or near the subject property. The Site was not identified on any of the database lists. The complete ERIIS report is presented in Appendix C.

#### 1.2.4 Review of Title Documents

A title search was not included in the scope of services for this assessment.

### 1.3 Geology

The site is located at an approximate elevation of 835 feet above mean sea level. The topography in the vicinity of the site slopes to the southeast. The site is located in the northwestern San Fernando Valley. The Simi Hills are about four miles to the west, and the Santa Susana Mountains are about two miles to the north. The Chatsworth Reservoir is about three miles to the west. The Site vicinity is underlain by up to 200 feet of Quaternary-aged alluvium deposited as part of the Browns Canyon alluvial fan. Near-surface alluvium in the western San Fernando Valley is typically



characterized as clay, silt, and fine-grained sand. However, a large percentage of coarse-grained sand and gravel may also be present, based on the site location with respect to the main fan channel.

#### **1.4 Hydrogeology**

The site is located within the San Fernando Valley Groundwater Basin. Faulting in the area affects groundwater occurrence and movement in this area of the basin. In the Site vicinity, groundwater flow is to the southeast and occurs at a depth between 25 and 50 feet below ground surface. Groundwater in the upper aquifer is not for beneficial use.

#### **1.5 Non-Cercla Issues**

##### **1.5.1 Asbestos**

Asbestos related issues were not identified during the site reconnaissance.

##### **1.5.2 Lead Paint**

Testing for lead paint was not included in the scope of this assessment.

##### **1.5.3 Lead in Drinking Water**

Potable drinking water is not currently available at the site.

##### **1.5.4 Radon**

The Site is not residential property and therefore, testing for radon was not included in the scope of services for this assessment.

##### **1.5.5 PCBs**

Evidence of PCBs was not observed during the site reconnaissance.

#### **1.6 Other**

AES did not identify other issues of concern.

#### **1.7 Environmental Issues**

AES did not identify current or past environmental issues during this assessment.

## **2.0 SURROUNDING PROPERTIES**

### **2.1 Description**

#### **2.1.1 Historical Use**

Historic aerial photographs reviewed at CSUN's Geography Map Library indicate that in 1975 and 1989, the properties adjacent to the site were developed in their current configuration. In 1952, 1938, and 1919, properties north, south, and east of the site are cultivated. The property west of the site is not visible in the photographs. A review of the Canoga Park USGS 7.5 Minute Quadrangle indicates that the adjacent properties were cultivated in 1952.

#### **2.1.2 Current Use**

Litton Guidance and Control Systems is south of the site. Their facility consists of office and other space used in the design, production, and testing of guidance and control systems used in military aerospace applications. The main parking lot servicing the facility is east of the property. Home Savings Bank, Black Angus Restaurant, a vacant office building, and Great Western Bank are adjacent on the west, across Corbin Avenue. A gym, RSA Lighting Warehouse, Chef Merito, Inc., which appears to be an office building, a company called CSC, and an unnamed business, which appears to do concrete casting border the site on the north.

### **2.2 Regulatory Review**

AES retained Environmental Risk Information & Imaging Services (ERIIS) to perform an environmental database search for locations identified as hazardous substance and/or hazardous waste sites near the subject property. The search distance from the site was determined by ASTM standards. The complete ERIIS report including the names and descriptions of the agency lists searched, the search distance from the site, and the date the list was last updated is presented in Appendix B. Facilities identified by ERIIS' search are summarized below.

#### **Resource Conservation & Recovery Information System (RCRIS)**

The US Environmental Protection Agency has developed and maintained lists of hazardous waste generators (large and small) and hazardous waste treatment storage facilities (TS) in the State of California, pursuant to the requirements of the Resource Conservation and Recovery Act (RCRA) under the Resource Conservation & Recovery Information System (RCRIS).

Large generators pertain to facilities that generate more than 1,000 kilograms of hazardous waste per month. Small generators pertain to facilities that generate between 100 kilograms

and 1,000 kilograms of hazardous waste per month. Information pertaining to the status of facilities is provided through the RCRA Administrative Action Tracking System (RAATS).

ERIIS did not identify RCRIS-TS facilities within one mile of the site or RCRIS-LG within one-quarter mile of the site. ERIIS identified one facility on the RCRIS-SG list within a quarter mile of the site. The facility, Great Western Bank Northridge is located about 350 feet west of the site. The facility is not reported in the RAATS and is unlikely to impact the Site at this time.

California Leaking Underground Storage Tank (LUST) Report

The California State Water Resources Control Board, in cooperation with the Office of Emergency Services, compiles lists of all leaks of hazardous substances from underground storage tanks in the State of California. The nine regional boards maintain information on all reported leak cases within their jurisdiction, both for those where the regional board and where other local agencies take the lead in overseeing investigations and remedial actions. The California Environmental Protection Agency's Department of Hazardous Materials Data Management collects the nine regional lists and publishes them as one database named LUST.

ERIIS identified eight California Leaking Underground Storage Tank (LUST) facilities within a one-half mile radius of the site. The facilities are summarized in the following table.

TABLE 1. LUST SITES IDENTIFIED WITHIN 0.5 MILE OF THE PROPERTY

SITE ADDRESS	CONTAMINANT AND CASE TYPE	STATUS	DISTANCE AND DIRECTION FROM SITE
Malibu Grand Prix (Toyota Dealership) 19550 Nordhoff Street, Northridge	Gasoline Groundwater Affected	Case Closed	200 Feet South
Chevron #9-0055 8900 Corbin Avenue, Northridge	Gasoline Undefined	Preliminary Assessment Underway	1,250 feet Southwest
Unocal #5732 19301 Nordhoff Street, Northridge	Diesel Undefined	Pollution Characterization Underway	1,250 feet west
Kahn Air Conditioning Inc. 19434 Business Center Drive, Northridge	Gasoline Undefined	Remediation Plan Under Development	2,400 feet southwest
Exxon #7-3417 19260 Nordhoff Street, Northridge	Gasoline Undefined	Pollution Characterization Underway	1,500 feet west
Northridge Fashion Center - May Co. 9301 Tampa Avenue, Northridge	Gasoline Groundwater Affected	Case Closed	1,250 northeast
Arco #1992 9454 Corbin Avenue, Northridge	Gasoline Undefined	Preliminary Assessment Underway	900 feet north
Riker Laboratories, Inc. 19901 Nordhoff Street, Northridge	Solvents Groundwater Affected	Remedial Action Underway	One-half mile southeast

Based on the status and locations of the identified facilities, they are unlikely to impact the environmental integrity of the site at this time.

### California Underground Storage Tank Report (RST)

The RST Report is a listing of all registered underground storage tanks located within the State of California. ERIIS identified two RST facilities within a quarter-mile radius of the site; West Hills Toyota Dealership, listed as Northridge Mggpc and The Canteen Corporation, located about a quarter of a mile southwest of the site. The type and capacity of the tanks are not listed. Both facilities are down gradient of the site and are unlikely to impact the Site at this time.

### California CalSites (HWS)

The California CalSites report contains information pertaining to the State Hazardous Waste Sites governed by the California Department of Toxic Substance Control (DTSC). Sites formerly listed in the Annual Workplan, the Abandoned Sites Project Information System (ASPIS), and the Bond Expenditure Plan (BEP) are now included in the CALSITES database.

ERIIS identified eleven HWS facilities within a one-mile radius of the site. None of these facilities are within a quarter mile of the site and do not pose a significant threat to the environmental integrity of the site at this time.

## **3.0 ANALYSIS AND CONCLUSIONS**

### **3.1 Subject Site**

Evidence of issues of environmental concern was not identified during the site reconnaissance.

### **3.2 Off-Site**

The ERIIS report identified several facilities within one mile of the Site on the various databases searched. Based on the locations and distances of these facilities with respect to the site, they are unlikely to impact the environmental integrity of the site at this time. See Section 2.2 for a detailed review of the listed facilities.

#### **4.0 LIMITATIONS**

AES is committed to providing quality consulting services. However, Phase I Site Assessment work is not an exact science. The possibility of field and general conditions, beyond AES' control, that affect our work or that present a concern for the safety of our employees, our consultants, building occupants, and the public at the site, and insurance constraints, requires that we qualify the services we provide with the following limitations:

Reasonable effort is made by AES' personnel to locate all suspect hazardous materials. However, for any facility the existence of unique concealed hazardous materials and underground storage tanks is a possibility.

AES does not employ professional cost estimators. Statements of probable construction cost or cost estimates prepared by AES represent AES' opinion of probable costs based upon current industry information. Actual costs may fluctuate due to several variables including, but not limited to, the time the work is performed, phasing, labor availability, quantity of work performed, product availability, specification requirements, and unforeseeable changes in the economy and environmental regulations.

AES is not, and has no responsibility as a generator, operator, treater, storer, transporter, or disposer of hazardous materials or waste found or identified as a result of AES' work.

This report was based on those conditions observed on the day(s) the field evaluation was accomplished. In the event that changes in the nature of the property have occurred, or additional relevant information about the property is subsequently discovered, the findings and recommendations contained in this report may not be valid unless these changes and additional relevant information are reviewed and the conclusion of this report is modified and verified in writing.

In preparing this report, AES has relied on documents furnished by the property owner, its tenant, and information in the public record. AES cannot be held liable for the accuracy of these documents or if pertinent documents were not furnished.

## **5.0 STATEMENT OF INDEPENDENCE**

This report has been prepared by the staff of American Environmental Specialists, Inc. (AES) for The Krausz Companies, Inc. under the professional supervision of the principal and/or senior staff whose seal and signature appear hereon. Neither AES, nor any staff member assigned to this investigation has any interest or contemplated interest, financial or otherwise, in the subject or surrounding properties, or in any entity which owns, leases, or occupies the subject or surrounding properties or which may be responsible for environmental issues identified during the course of this investigation, and has no personal bias with respect to the parties involved.

The information contained in this report has received appropriate technical review and approval. The conclusions represent professional judgments and are founded upon the findings of the investigations identified in the report and the interpretation of such data based on our experience and expertise according to the existing standard of care. No other warranty or limitation exists, either express or implied.

**APPENDIX "A"**

**FIGURES**

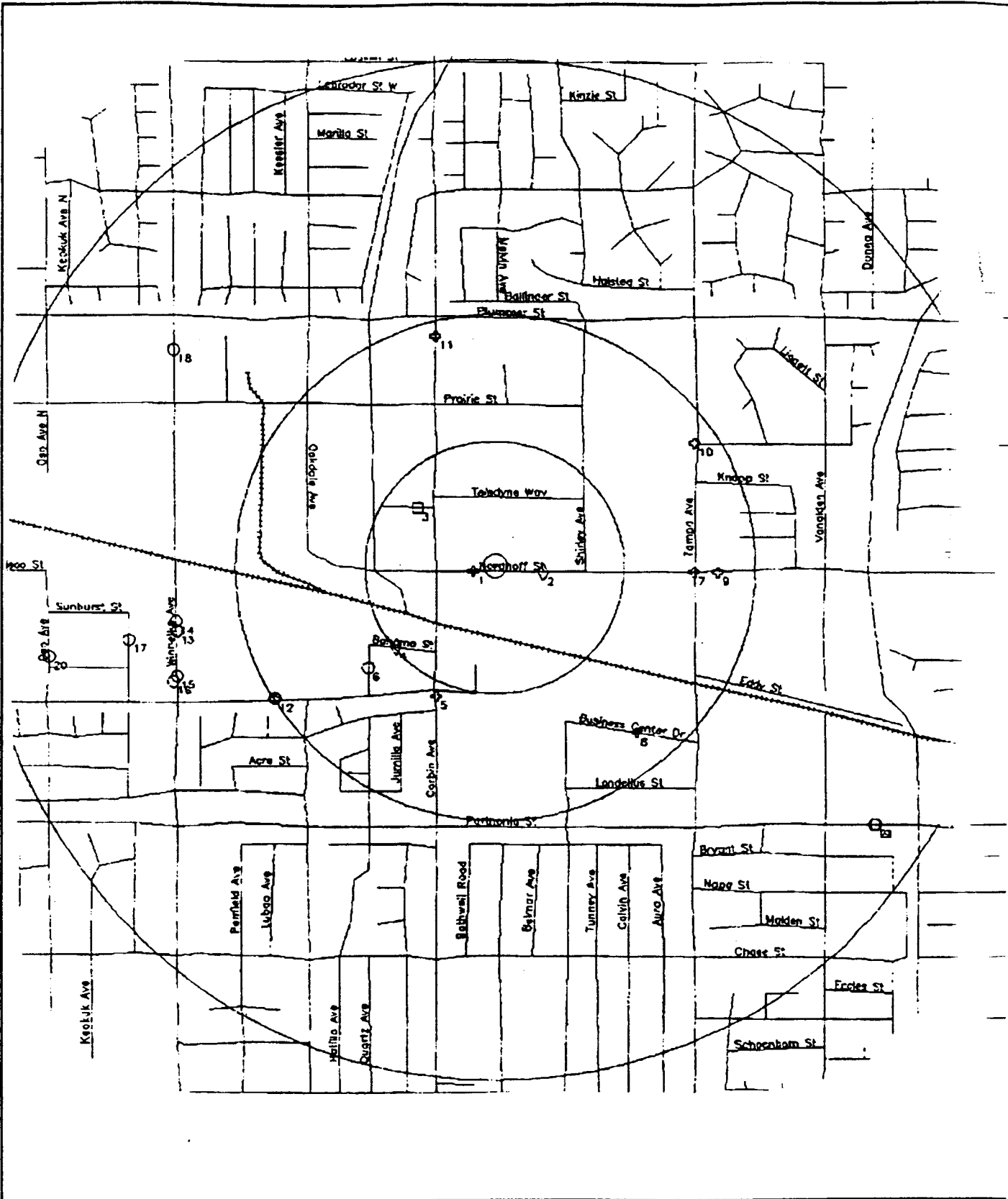

Figure A.1

Property Vicinity Map

AMERICAN ENVIRONMENTAL SPECIALIST, CO.  
 7400 Center Avenue, Suite 113  
 Huntington Beach, CA 92647

PH 714-379-3333 Fax 714-379-3338



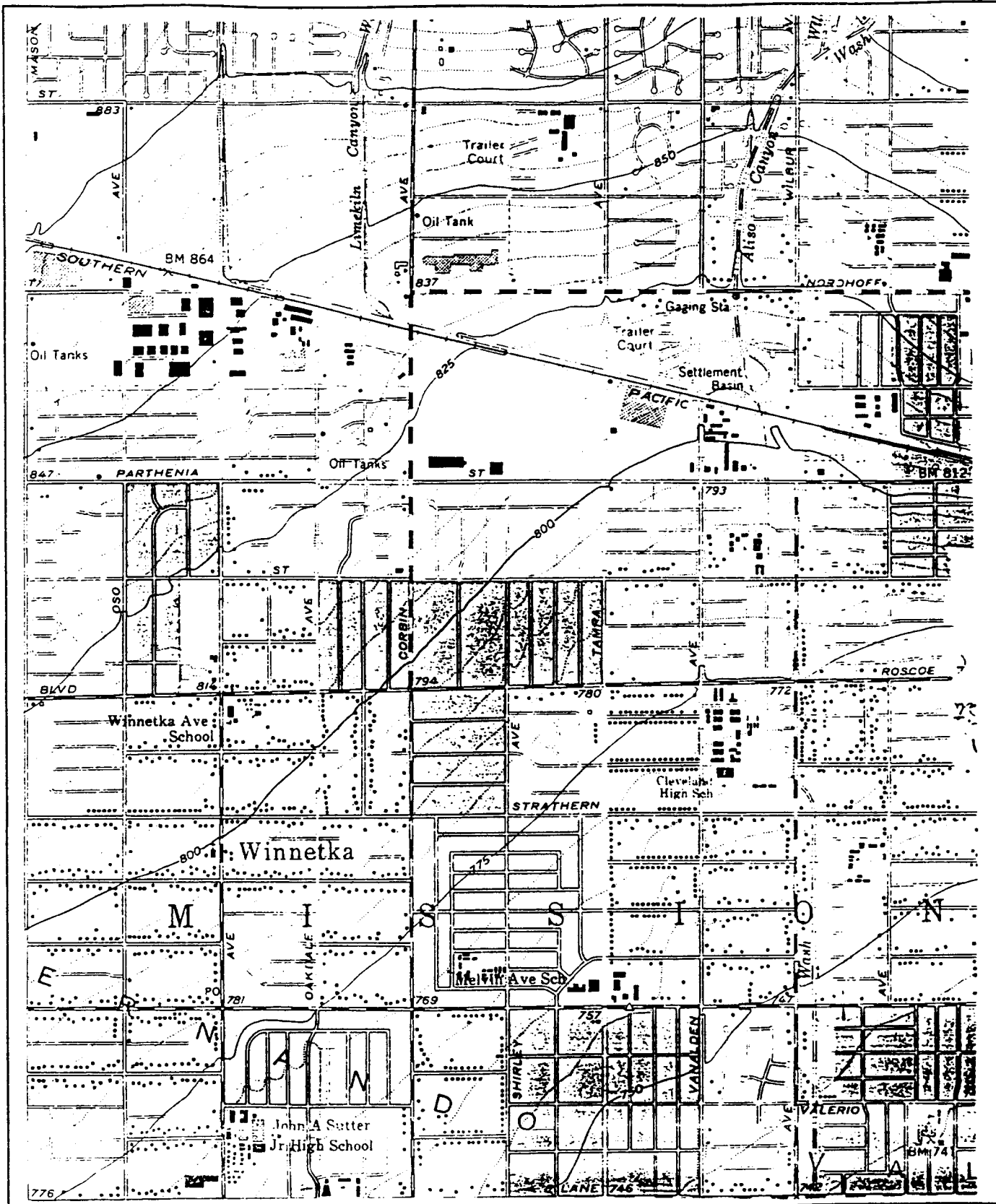

Figure A.2

USGS Topographic Map  
 Canoga Park Quadrangle, 1952  
 (photorevised 1967)

AMERICAN ENVIRONMENTAL SPECIALIST, CO.  
 7400 Center Avenue, Suite 113  
 Huntington Beach, CA 92647

PH 714-379-3333 Fax 714-379-3338

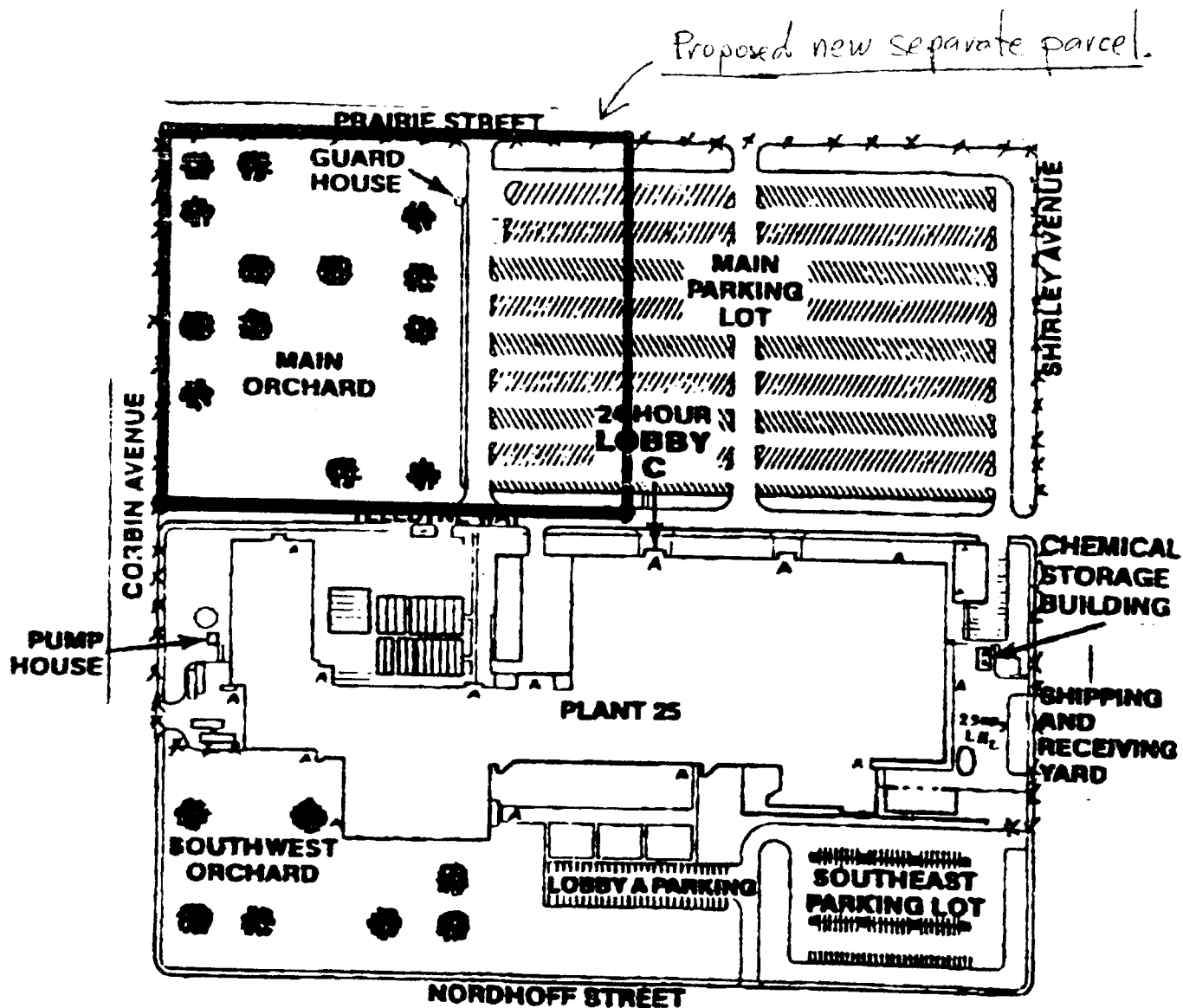

Figure A.3  
Site Plan

AMERICAN ENVIRONMENTAL SPECIALIST, CO  
7400 Center Avenue, Suite 113  
Huntington Beach, CA 92647

PH 714-379-3333 Fax 714-379-3338

**APPENDIX "B"**

**REFERENCES**

## REFERENCES

Upper Los Angeles River Area Watermaster, 1992, Watermaster Service in the Upper Los Angeles River Area, Los Angeles, County, October 1, 1990 - September 30, 1991: Report published May 1992

Thomas Bros. Maps, 1995, Los Angeles County Street Guide & Directory: Thomas Bros. Maps, Irvine, CA.

US Geological Survey (USGS), 1952, Canoga Park Quadrangle, California, 7.5-minute series (topographic; photo-revised, 1967): USGS, scale 1:24,000, 1 sheet.

Environmental Risk Imaging and Information System, Report for 19601 Nordhoff Street, Northridge, California, August 1996.

**APPENDIX "C"**

**ERIIS REPORT AND  
OTHER REPORTS**

SUBJECT PROPERTY: 19601 Nordhoff Street  
Northridge, CA 91324

ORDERED BY: American Environmental Specialists,

ERIIS DISCLAIMER

The Information contained in the ERIIS Report has been obtained from publicly available data sources and other secondary sources of information produced by entities other than ERIIS. Although reasonable care has been taken by ERIIS in compiling the information contained in the Report, ERIIS disclaims any and all liability for any errors, omissions or inaccuracies in this information. THIS REPORT DOES NOT CONSTITUTE A LEGAL OR PROFESSIONAL OPINION AND IS NOT AN ENVIRONMENTAL RISK AUDIT OR ASSESSMENT. THE DATA AND REPORTS ARE PROVIDED "AS IS". ERIIS MAKES NO REPRESENTATIONS OR WARRANTIES OF ANY KIND WHATSOEVER WITH RESPECT TO THE DATA OR THE REPORTS INCLUDING, BUT NOT LIMITED TO, THEIR CORRECTNESS, COMPLETENESS, CURRENTNESS, FITNESS FOR A PARTICULAR PURPOSE OR MERCHANTABILITY, NOR ARE SUCH REPRESENTATIONS OR WARRANTIES TO BE IMPLIED WITH RESPECT TO THE DATA OR REPORTS FURNISHED AND ERIIS ASSUMES NO RESPONSIBILITY WITH RESPECT TO THE PURCHASER'S USE THEREOF. ERIIS SHALL HAVE NO LIABILITY, IN CONTRACT, TORT OR OTHERWISE, FOR ANY INACCURACY OR DEFECT OR OMISSION IN PROCURING, COMPILING, COLLECTING, INTERPRETING, REPORTING, COMMUNICATING OR DELIVERING THE REPORTS OR DATA OR ANY OTHER MATTER RELATED TO CUSTOMER'S USE OF THE SERVICE, WITHOUT LIMITING THE GENERALITY OF THE FOREGOING. NONE OF ERIIS, ITS PARTNERS, OFFICERS, EMPLOYEES OR DATA SUPPLIERS SHALL IN ANY EVENT HAVE ANY LIABILITY FOR LOST PROFITS OR FOR ANY OTHER INDIRECT, SPECIAL, INCIDENTAL, CONSEQUENTIAL, EXEMPLARY OR PUNITIVE DAMAGES. Each Report is valid only for the geographical parameters and as of the date specified on the cover page of such Report, and any alteration or deviation from the description, or any subsequent use, will require a new Report. In the case of any Data obtained from a Data Supplier, ERIIS will advise the Data Supplier of any inaccuracies reported to it, but can take no responsibility for the accuracy or completeness of the Data provided to the Purchaser under this Agreement.

ERIIS ASTM Detail Radius Statistical Profile

ERIIS Report #109199A

Aug 30, 199

SITE: 19601 Nordhoff Street  
Northridge, CA 91324

Latitude: 34.235410  
Longitude: -118.559350

State: CA

DATABASE	RADIUS (MI)	PROPERTY AREA**	PROPERTY-1/4	1/4-1/2	1/2-1	>1	TOTAL
NPL	1.00		0	0	0		0
CERCLIS	0.50		0	0			0
RCRIS_TS	1.00		0	0	0		0
RCRIS_LG	0.25		0				0
RCRIS_SG	0.25		1				1
ERNS	0.05		0				0
LRST	0.50	X	1	7			8
RST	0.25		2				2
SWF	0.50		0	0			0
HWS	1.00		0	2	9		11
NFRAP	0.50		0	1			1
OGW	0.25		0				0
			4	10	9	0	23

Radon Zone Level: NOT REPORTED

A Radon Zone should not be used to determine if individual homes need to be tested for radon. The EPA's Office of Radiation and Indoor Air (202/233-9320) recommends that all homes be tested for radon, regardless of geographic location or the zone designation in which the property is located.

\*\*A property is defined as a .05 mile buffer around the site's latitude and longitude.

A blank radius count indicates that the database was not searched by this radius per client instructions. NR in a radius count indicates that the database cannot be reported by this search criteria due to insufficient and/or inaccurate addresses reported by a federal/state agency.

ENVIRONMENTAL RISK INFORMATION & IMAGING SERVICES  
DATABASE REFERENCE GUIDE

NPL

Date of Data: 05/01/96  
Release Date: 05/13/96  
US Environmental Protection Agency  
Office of Solid Waste and Emergency Response  
703/603-8881

National Priorities List

The NPL Report, also known as the Superfund List, is an EPA listing of uncontrolled or abandoned hazardous waste sites. The list is primarily based upon a score which the site receives from the EPA's Hazardous Ranking System. These sites are targeted for possible long-term remedial action under the Superfund Act of 1980.

CERCLIS

Date of Data: 05/01/96  
Release Date: 05/13/96  
US Environmental Protection Agency  
Office of Solid Waste and Emergency Response  
703/603-8730

Comprehensive Environmental Response, Compensation, and Liability Information System

The CERCLIS Database is a comprehensive listing of known or suspected uncontrolled or abandoned hazardous waste sites. These sites have either been investigated, or are currently under investigation by the U.S. EPA for the release, or threatened release of hazardous substances. Once a site is placed in CERCLIS, it may be subjected to several levels of review and evaluation, and ultimately placed on the National Priorities List (NPL). As of February 1995, CERCLIS sites designated "No Further Remedial Action Planned" (NFRAP) have been removed from the CERCLIS Database.

RCRIS\_TS

Date of Data: 05/10/96  
Release Date: 06/10/96  
US Environmental Protection Agency  
Office of Solid Waste and Emergency Response  
202/260-4610

Resource Conservation and Recovery Information System - Treatment, Storage, And Disposal Facilities

The RCRIS\_TS Report contains information pertaining to facilities which either treat, store, or dispose of EPA regulated hazardous waste. The following information is also included in the RCRIS\_TS Report:

- Information pertaining to the status of facilities tracked by the RCRA Administrative Action Tracking System (RAATS)
- Inspections & evaluations conducted by federal and state agencies
- All reported facility violations, the environmental statute(s) violated, and any proposed & actual penalties
- Information pertaining to corrective actions undertaken by the facility or EPA
- A complete listing of EPA regulated hazardous wastes which are generated or stored on-site

RCRIS\_LG

Date of Data: 05/10/96  
Release Date: 06/10/96  
US Environmental Protection Agency  
Office of Solid Waste and Emergency Response  
202/260-4610

Resource Conservation and Recovery Information System - Large Quantity Generators

The RCRIS\_LG Report contains information pertaining to facilities which either generate more than 1000kg of EPA regulated hazardous waste per month, or meet other applicable requirements of the Resource Conservation And Recovery Act. The following information is also included in the RCRIS\_LG Report:

- Information pertaining to the status of facilities tracked by the RCRA Administrative Action Tracking System (RAATS)
- Inspections & evaluations conducted by federal and state agencies
- All reported facility violations, the environmental statute(s) violated, and any proposed & actual penalties
- Information pertaining to corrective actions undertaken by the facility or EPA
- A complete listing of EPA regulated hazardous wastes which are generated or stored on-site



ENVIRONMENTAL RISK INFORMATION & IMAGING SERVICES  
DATABASE REFERENCE GUIDE

SWF

Date of Data: 04/15/96  
Release Date: 04/19/96  
CA Intergrated Waste Management Board  
Solid Waste Information System Program  
916/255-2330

California Solid Waste Information System

The California Solid Waste Information System Report, commonly known as the SWIS Report, contains information pertaining to all permitted and unpermitted active and inactive solid waste landfills, proposed disposal sites, transfer stations, and materials recovery facilities located within the State of California.

HWS

Date of Data: 04/13/96  
Release Date: 04/30/96  
CA Dept. of Toxic Substances Control  
Site Mitigation Branch/CalSites  
916/323-3400

California Calsites

The California CalSites Report contains information pertaining to potentially contaminated hazardous waste sites. Sites formerly listed in the Annual Workplan (AWP), the Abandoned Sites Project Information System (ASPIS), and the Bond Expenditure Plan (BEP) are now included in the CalSites Database. Of the 26,000+ sites listed within CalSites, approximately 16,000 sites are listed as "No Further Action". Further, only about 300+ sites listed within the CalSites database are confirmed and active hazardous substance release sites.

NFRAP

Date of Data: 05/01/96  
Release Date: 05/13/96  
US Environmental Protection Agency  
Office of Solid Waste and Emergency Response  
703/603-8881

No Further Remedial Action Planned Sites

The No Further Remedial Action Planned Report (NFRAP), also known as the CERCLIS Archive, contains information pertaining to sites which have been removed from the U.S. EPA's CERCLIS Database. NFRAP sites may be sites where, following an initial investigation, either no contamination was found, contamination was removed quickly without need for the site to be placed on the NPL, or the contamination was not serious enough to require federal Superfund action or NPL consideration.

OGW

Date of Data: 12/01/93  
Release Date: 05/27/94  
Petroleum Information Corporation  
  
303/595-7500

California Oil and Gas Well Report

The California Oil and Gas Well Data Report contains location and production information for all regulated oil and gas wells located within the State of California.

If a selected database does not appear on this list, it is not available for the subject property's state.

ERIIS ID. DATABASE	FACILITY ADDRESS COMMENTS	DISTANCE FROM SITE	DIRECTION FROM SITE	MAP ID
0 - 1/4 Miles				
06005013011 LRST	Malibu Grand Prix 19550 Nordhoff St Northridge, CA 91324-2419 County: Los Angeles	.042 Mi	SOUTHWEST	1
06010039472 RST	Northridge Mgpc 19550 Nordhoff St Northridge, CA 91324-2419 County: Los Angeles	.092 Mi	SOUTHEAST	2
06008019281 RCRIS_SG	Great Western Bank Northridge 19735 Dearborn St Chatsworth, CA 91311-6510 County: Los Angeles	.188 Mi	NORTHWEST	3
06010009632 RST	Canteen Corporation 19761 Bahama St Northridge, CA 91324-3304 County: Los Angeles	.247 Mi	SOUTHWEST	4
1/4 - 1/2 Miles				
06005004867 LRST	Chevron #9-0055 8900 Corbin Ave Northridge, CA 91324-3311 County: Los Angeles	.280 Mi	SOUTHWEST	5
06039001598 NFRAP	Metals Technology Inc 8955 Quartz Ave Northridge, CA 91324-3340 County: Los Angeles	.314 Mi	SOUTHWEST	6
06040006615 HWS	Metals Technology Inc 8955 Quartz Ave Northridge, CA 91324-3340 County: Los Angeles	.314 Mi	SOUTHWEST	6
06005022980 LRST	Unocal #5732 19301 Nordhoff St Northridge, CA 91324-2416 County: Los Angeles	.385 Mi	SOUTHEAST	7
06005011714 LRST	Kahn Air Conditioning Inc 19434 Business Center Dr Northridge, CA 91324-3505 County: Los Angeles	.429 Mi	SOUTHEAST	8
06005008149 LRST	Exxon #7-3417 19260 Nordhoff St Northridge, CA 91324-3615 County: Los Angeles	.430 Mi	SOUTHEAST	9
06005015069 LRST	Northridge Fashion Center-may 9301 Tampa Ave Northridge, CA 91324-2503 County: Los Angeles	.460 Mi	NORTHEAST	10
06005001531 LRST	Arco #1992 9454 Corbin Ave Northridge, CA 91324-2407 County: Los Angeles	.472 Mi	NORTHWEST	11
06040006674 HWS	Riker Laboratories Inc 19901 Nordhoff St Northridge, CA 91324-3213 County: Los Angeles	.498 Mi	SOUTHWEST	12
06005017331 LRST	Riker Laboratories Inc 19901 Nordhoff St Northridge, CA 91324-3213 County: Los Angeles	.498 Mi	SOUTHWEST	12

ERIIS ID. DATABASE	FACILITY ADDRESS COMMENTS	DISTANCE FROM SITE	DIRECTION FROM SITE	MAP ID
1/2 - 1 Miles				
06040009182 HWS	Maroney Company 9016 Winnetka Ave Northridge, CA 91324-3235 County: Los Angeles	.626 Mi	SOUTHWEST	14
06040009404 HWS	American Cast Alloys 9000 Winnetka Ave Northridge, CA 91324-3235 County: Los Angeles	.630 Mi	SOUTHWEST	13
06040009703 HWS	Commercial Recovery 8933 Winnetka Ave Chatsworth, CA 91311-6221 County: Los Angeles	.653 Mi	SOUTHWEST	15
06040009704 HWS	Trompeter Electronics 8927 Winnetka Avenue Canoga Park, CA 91306 County: Los Angeles	.663 Mi	SOUTHWEST	16
06040009600 HWS	Canoga Electronics Corp 8966 Comanche Ave Chatsworth, CA 91311-6208 County: Los Angeles	.726 Mi	SOUTHWEST	17
06040006684 HWS	Signature Products Inc 9421 Winnetka Ave Chatsworth, CA 91311-6042 County: Los Angeles	.755 Mi	NORTHWEST	18
06040006665 HWS	Precision Tile Spacers 8943 Oso Ave Chatsworth, CA 91311-6214 County: Los Angeles	.885 Mi	SOUTHWEST	20
06040007695 HWS	Standard Abrasives Inc 19015 Parthenia St Northridge, CA 91324-3765 County: Los Angeles	.893 Mi	SOUTHEAST	19
06040006043 HWS	Techni-glass 19011 Parthenia St Northridge, CA 91324-3727 County: Los Angeles	.897 Mi	SOUTHEAST	21

---

ERIS ID	FACILITY	ADDRESS	MAP ID
06008019281	Great Western Bank Northridge	19735 Dearborn St	3
CAD983669136	DISTANCE FROM SITE: .188 Miles DIRECTION FROM SITE: Northwest	Chatsworth, CA 91311-6510 County: Los Angeles	

---

Facility Is Not Reported In Raats

HAZARDOUS WASTES:

1.	WASTE CODE:	D001	AMOUNT OF WASTE:	.00000
	SOURCE OF INFO:	Notification		
2.	WASTE CODE:	D002	AMOUNT OF WASTE:	.00000
	SOURCE OF INFO:	Notification		

---

ERIIS ID	FACILITY	ADDRESS	MAP ID
06005013011	Malibu Grand Prix DISTANCE FROM SITE: .042 Miles DIRECTION FROM SITE: Southwest	19550 Nordhoff St Northridge, CA 91324-2419 COUNTY: Los Angeles	1
	CASE NO.: 913240516 REPORT DATE: 05/02/88 CASE TYPE: Other CASE CLOSED: REMEDIAL ACTION: 10/01/91 REMEDICATION PLAN: LEAK BEING CONFIRMED: LEAK CAUSE: Not Reported	STATUS: Case Closed SUBSTANCE: Gasoline ABATEMENT METHOD: Pump And Treat POLLUTION CHARACTERIZATION: 01/10/89 POST REMEDIAL ACTION MONITORING: PRELIMINARY SITE ASSESSMENT UNDERWAY: PRELIMINARY SITE ASSESSMENT WORKPLAN SUBMITTED:	
06005004867	Chevron #9-0055 DISTANCE FROM SITE: .280 Miles DIRECTION FROM SITE: Southwest	8900 Corbin Ave Northridge, CA 91324-3311 COUNTY: Los Angeles	5
	CASE NO.: 121594-27 REPORT DATE: 11/01/93 CASE TYPE: Undefined CASE CLOSED: REMEDIAL ACTION: REMEDICATION PLAN: LEAK BEING CONFIRMED: LEAK CAUSE: Not Reported	STATUS: Preliminary Site Assessment Underway SUBSTANCE: Gasoline ABATEMENT METHOD: Not Reported POLLUTION CHARACTERIZATION: POST REMEDIAL ACTION MONITORING: PRELIMINARY SITE ASSESSMENT UNDERWAY: 11/01/93 PRELIMINARY SITE ASSESSMENT WORKPLAN SUBMITTED:	
06005022980	Unocal #5732 DISTANCE FROM SITE: .385 Miles DIRECTION FROM SITE: Southeast	19301 Nordhoff St Northridge, CA 91324-2416 COUNTY: Los Angeles	7
	CASE NO.: 003025 REPORT DATE: 04/22/86 CASE TYPE: Undefined CASE CLOSED: REMEDIAL ACTION: REMEDICATION PLAN: LEAK BEING CONFIRMED: LEAK CAUSE: Not Reported	STATUS: Pollution Characterization SUBSTANCE: Diesel ABATEMENT METHOD: Not Reported POLLUTION CHARACTERIZATION: 06/23/92 POST REMEDIAL ACTION MONITORING: PRELIMINARY SITE ASSESSMENT UNDERWAY: PRELIMINARY SITE ASSESSMENT WORKPLAN SUBMITTED:	
	CASE NO.: 3025 REPORT DATE: 04/22/86 CASE TYPE: Undefined CASE CLOSED: REMEDIAL ACTION: REMEDICATION PLAN: LEAK BEING CONFIRMED: LEAK CAUSE: Not Reported	STATUS: Pollution Characterization SUBSTANCE: Diesel ABATEMENT METHOD: Not Reported POLLUTION CHARACTERIZATION: POST REMEDIAL ACTION MONITORING: PRELIMINARY SITE ASSESSMENT UNDERWAY: PRELIMINARY SITE ASSESSMENT WORKPLAN SUBMITTED:	
06005011714	Kahn Air Conditioning Inc DISTANCE FROM SITE: .429 Miles DIRECTION FROM SITE: Southeast	19434 Business Center Dr Northridge, CA 91324-3505 COUNTY: Los Angeles	8
	CASE NO.: 913240643 REPORT DATE: 12/05/94 CASE TYPE: Other CASE CLOSED: REMEDIAL ACTION: REMEDICATION PLAN: 08/03/95 LEAK BEING CONFIRMED: LEAK CAUSE: Not Reported	STATUS: Remediation Plan SUBSTANCE: Gasoline ABATEMENT METHOD: Not Reported POLLUTION CHARACTERIZATION: POST REMEDIAL ACTION MONITORING: PRELIMINARY SITE ASSESSMENT UNDERWAY: PRELIMINARY SITE ASSESSMENT WORKPLAN SUBMITTED:	
06005008149	Exxon #7-3417 DISTANCE FROM SITE: .430 Miles DIRECTION FROM SITE: Southeast	19260 Nordhoff St Northridge, CA 91324-3615 COUNTY: Los Angeles	9

ERIIS ID	FACILITY	ADDRESS	MAP ID
CASE NO.: 032090-01 REPORT DATE: 03/13/90 CASE TYPE: Other CASE CLOSED: REMEDIAL ACTION: REMEDIATION PLAN: LEAK BEING CONFIRMED: LEAK CAUSE: Not Reported	STATUS: Pollution Characterization SUBSTANCE: Gasoline ABATEMENT METHOD: Not Reported POLLUTION CHARACTERIZATION: 02/07/92 POST REMEDIAL ACTION MONITORING: PRELIMINARY SITE ASSESSMENT UNDERWAY: PRELIMINARY SITE ASSESSMENT WORKPLAN SUBMITTED: 03/13/90		
06005015069	Northridge Fashion Center-may DISTANCE FROM SITE: .460 Miles DIRECTION FROM SITE: Northeast	9301 Tampa Ave Northridge, CA 91324-2503 COUNTY: Los Angeles	10
CASE NO.: 913240370 REPORT DATE: 07/17/87 CASE TYPE: Other CASE CLOSED: 12/21/94 REMEDIAL ACTION: 04/05/89 REMEDIATION PLAN: LEAK BEING CONFIRMED: LEAK CAUSE: Not Reported	STATUS: Case Closed SUBSTANCE: Gasoline ABATEMENT METHOD: Pump And Treat POLLUTION CHARACTERIZATION: 04/06/88 POST REMEDIAL ACTION MONITORING: PRELIMINARY SITE ASSESSMENT UNDERWAY: PRELIMINARY SITE ASSESSMENT WORKPLAN SUBMITTED:		
06005001531	Arco #1992 DISTANCE FROM SITE: .472 Miles DIRECTION FROM SITE: Northwest	9454 Corbin Ave Northridge, CA 91324-2407 COUNTY: Los Angeles	11
CASE NO.: 024459 REPORT DATE: 07/20/92 CASE TYPE: Undefined CASE CLOSED: REMEDIAL ACTION: REMEDIATION PLAN: LEAK BEING CONFIRMED: LEAK CAUSE: Not Reported	STATUS: Preliminary Site Assessment Underway SUBSTANCE: Gasoline ABATEMENT METHOD: Not Reported POLLUTION CHARACTERIZATION: POST REMEDIAL ACTION MONITORING: PRELIMINARY SITE ASSESSMENT UNDERWAY: 07/20/92 PRELIMINARY SITE ASSESSMENT WORKPLAN SUBMITTED:		
CASE NO.: 24459 REPORT DATE: 07/20/92 CASE TYPE: Undefined CASE CLOSED: REMEDIAL ACTION: REMEDIATION PLAN: LEAK BEING CONFIRMED: LEAK CAUSE: Not Reported	STATUS: Preliminary Site Assessment Underway SUBSTANCE: Gasoline ABATEMENT METHOD: Not Reported POLLUTION CHARACTERIZATION: POST REMEDIAL ACTION MONITORING: PRELIMINARY SITE ASSESSMENT UNDERWAY: PRELIMINARY SITE ASSESSMENT WORKPLAN SUBMITTED:		
06005017331	Riker Laboratories Inc DISTANCE FROM SITE: .498 Miles DIRECTION FROM SITE: Southwest	19901 Nordhoff St Northridge, CA 91324-3213 COUNTY: Los Angeles	12
CASE NO.: 913240289 REPORT DATE: 11/18/83 CASE TYPE: Aquifer Affected CASE CLOSED: REMEDIAL ACTION: 03/08/96 REMEDIATION PLAN: LEAK BEING CONFIRMED: LEAK CAUSE: Not Reported	STATUS: Remedial Action Underway SUBSTANCE: Solvents ABATEMENT METHOD: Pump And Treat POLLUTION CHARACTERIZATION: 12/12/88 POST REMEDIAL ACTION MONITORING: PRELIMINARY SITE ASSESSMENT UNDERWAY: PRELIMINARY SITE ASSESSMENT WORKPLAN SUBMITTED:		

CALIFORNIA UNDERGROUND STORAGE TANKS  
RST - PLOTTABLE SITES - PAGE 1

ERIIS Report #109199A

Aug 30, 1996

ERIIS ID	FACILITY	ADDRESS	MAP ID
06010039472	Northridge Mgp DISTANCE FROM SITE: .092 Miles DIRECTION FROM SITE: Southeast	19550 Nordhoff St Northridge, CA 91324-2419 COUNTY: Los Angeles	2
BUSINESS DESCRIPTION: Other		MANAGER: N/a (818) 886-3262	
OWNER TANK ID: Not Reported CAPACITY: 0 STATUS: Not Reported		TANK DESCRIPTION: Not Reported TANK MATERIAL: Not Reported SUBSTANCE: Not Reported	
06010009632	Canteen Corporation DISTANCE FROM SITE: .247 Miles DIRECTION FROM SITE: Southwest	19761 Bahama St Northridge, CA 91324-3304 COUNTY: Los Angeles	4
BUSINESS DESCRIPTION: Other		MANAGER: Unknown (213) 000-0000	
OWNER TANK ID: Not Reported CAPACITY: 0 STATUS: Not Reported		TANK DESCRIPTION: Not Reported TANK MATERIAL: Not Reported SUBSTANCE: Not Reported	

CALIFORNIA CALSITES  
HWS - PLOTTABLE SITES - PAGE 1

ERIIS Report #109199A

Aug 30, 1991

ERIIS ID FACILITY ID	FACILITY	ADDRESS	MAP ID
06040006615 19280636	Metals Technology Inc DISTANCE FROM SITE: .314 Miles DIRECTION FROM SITE: Southwest	8955 Quartz Ave Northridge, CA 91324-3340 COUNTY: Los Angeles	6
<p>CALSITE STATUS DATE: 11/01/85    CALSITE STATUS: No Further Action For Dtsc GROUNDWATER STATUS: Not Reported</p>			
06040006674 19280700	Riker Laboratories Inc DISTANCE FROM SITE: .498 Miles DIRECTION FROM SITE: Southwest	19901 Nordhoff St Northridge, CA 91324-3213 COUNTY: Los Angeles	12
<p>CALSITE STATUS DATE: 09/20/82    CALSITE STATUS: No Further Action For Dtsc GROUNDWATER STATUS: Not Reported</p>			
06040009182 19350423	Maroney Company DISTANCE FROM SITE: .626 Miles DIRECTION FROM SITE: Southwest	9016 Winnetka Ave Northridge, CA 91324-3235 COUNTY: Los Angeles	14
<p>CALSITE STATUS DATE: 01/30/88    CALSITE STATUS: Preliminary Endangerment Assessment Req - Low GROUNDWATER STATUS: Not Reported</p>			
06040009404 19360190	American Cast Alloys DISTANCE FROM SITE: .630 Miles DIRECTION FROM SITE: Southwest	9000 Winnetka Ave Northridge, CA 91324-3235 COUNTY: Los Angeles	13
<p>CALSITE STATUS DATE: 03/22/83    CALSITE STATUS: Site Screening Required GROUNDWATER STATUS: Not Reported</p>			
06040009703 19360508	Commercial Recovery DISTANCE FROM SITE: .653 Miles DIRECTION FROM SITE: Southwest	8933 Winnetka Ave Chatsworth, CA 91311-6221 COUNTY: Los Angeles	15
<p>CALSITE STATUS DATE: 10/25/94    CALSITE STATUS: No Further Action For Dtsc GROUNDWATER STATUS: Not Reported</p>			
06040009704 19360509	Trompeter Electronics DISTANCE FROM SITE: .663 Miles DIRECTION FROM SITE: Southwest	8927 Winnetka Avenue Canoga Park, CA 91306 COUNTY: Los Angeles	16
<p>CALSITE STATUS DATE: 07/30/84    CALSITE STATUS: Site Screening Required GROUNDWATER STATUS: Not Reported</p>			
06040009600 19360402	Canoga Electronics Corp DISTANCE FROM SITE: .726 Miles DIRECTION FROM SITE: Southwest	8966 Comanche Ave Chatsworth, CA 91311-6208 COUNTY: Los Angeles	17
<p>CALSITE STATUS DATE: 04/27/83    CALSITE STATUS: No Further Action For Dtsc GROUNDWATER STATUS: Not Reported</p>			
06040006684 19280711	Signature Products Inc DISTANCE FROM SITE: .755 Miles DIRECTION FROM SITE: Northwest	9421 Winnetka Ave Chatsworth, CA 91311-6042 COUNTY: Los Angeles	18
<p>CALSITE STATUS DATE: 09/20/82    CALSITE STATUS: No Further Action For Dtsc GROUNDWATER STATUS: Not Reported</p>			
06040006665 19280691	Precision Tile Spacers DISTANCE FROM SITE: .885 Miles DIRECTION FROM SITE: Southwest	8943 Oso Ave Chatsworth, CA 91311-6214 COUNTY: Los Angeles	20
<p>CALSITE STATUS DATE: 09/20/82    CALSITE STATUS: No Further Action For Dtsc GROUNDWATER STATUS: Not Reported</p>			



---

ERIIS ID FACILITY ID	FACILITY	ADDRESS	MAP ID
-------------------------	----------	---------	--------

---

06040007695 19320127	Standard Abrasives Inc DISTANCE FROM SITE: .893 Miles DIRECTION FROM SITE: Southeast	19015 Parthenia St Northridge, CA 91324-3765 COUNTY: Los Angeles	19
-------------------------	--------------------------------------------------------------------------------------------	------------------------------------------------------------------------	----

CALSITE STATUS DATE: 07/30/84      CALSITE STATUS: Site Screening Required  
GROUNDWATER STATUS: Not Reported

---

06040006043 19270307	Techni-glass DISTANCE FROM SITE: .897 Miles DIRECTION FROM SITE: Southeast	19011 Parthenia St Northridge, CA 91324-3727 COUNTY: Los Angeles	21
-------------------------	----------------------------------------------------------------------------------	------------------------------------------------------------------------	----

CALSITE STATUS DATE: 06/13/83      CALSITE STATUS: No Further Action For Dts  
GROUNDWATER STATUS: Not Reported

---

---

ERIIS ID EPA ID	FACILITY	ADDRESS	MAP ID
06039001598 CAD981371107	Metals Technology Inc DISTANCE FROM SITE: .314 Miles DIRECTION FROM SITE: Southwest	8955 Quartz Ave Northridge, CA 91324-3340 COUNTY: Los Angeles	6
	SITE EVENT(S)	COMPLETE DATE	
	Discovery	02/01/86	
	Preliminary Assessment	06/01/86	

---

ERIIS ID. DATABASE	FACILITY ADDRESS COMMENTS	SELECTED BY
06010020858 RST	Fire Station #28 11641 Corbin Los Angeles, CA 91324 County: Los Angeles	ZIP code
06010002857 RST	Amphibians West 7450 Hayvenhurst Van Nuys, CA 91324 County: Los Angeles	ZIP code
06010000263 RST	3m Pharmaceuticals /c 19901 Nordhoff St Northridge, CA 91324-3213 County: Los Angeles	ZIP code
06042002141 SWF	CA County: Los Angeles	County
06042002145 SWF	CA County: Los Angeles	County
06042002150 SWF	21st Century Recycling Center CA County: Los Angeles	County
06042002147 SWF	A & J Tires CA County: Los Angeles	County
06042002148 SWF	A & J Tires CA County: Los Angeles	County
06042002132 SWF	A-auto CA County: Los Angeles	County
06042002149 SWF	Airport Tires CA County: Los Angeles	County
06042002146 SWF	American Tire Collection Inc. CA County: Los Angeles	County
06042002126 SWF	Apollo Tires CA County: Los Angeles	County
06042002127 SWF	Armando Auto Service CA County: Los Angeles	County
06042002128 SWF	Art Tire Co. CA County: Los Angeles	County

ERIIS ID. DATABASE	FACILITY ADDRESS COMMENTS	SELECTED BY
06042002133 SWF	B & D Auto Wrecking CA County: Los Angeles	County
06042002121 SWF	Caldwell Tire, Inc. CA County: Los Angeles	County
06042002140 SWF	Capro International CA County: Los Angeles	County
06042002116 SWF	Chase Tires CA County: Los Angeles	County
06042002139 SWF	Checker Tire & Wheel CA County: Los Angeles	County
06042002129 SWF	Cicer's Tire CA County: Los Angeles	County
06042002130 SWF	City Tireco CA County: Los Angeles	County
06042002125 SWF	Daniel's Tires CA County: Los Angeles	County
06042002106 WF	Daniels Tire Service CA County: Los Angeles	County
06042002137 WF	Daniels Tire Service CA County: Los Angeles	County
06042002118 WF	Drexler Tires & Rubber Co. CA County: Los Angeles	County
06042002120 WF	Drive Service CA County: Los Angeles	County
06042002143 WF	Ecology Auto Wrecking Inc. CA County: Los Angeles	County
06042002136 WF	Enrique Tovar's Tire Site CA County: Los Angeles	County

ERIIS ID. DATABASE	FACILITY ADDRESS COMMENTS	SELECTED BY
06042002104 SWF	Eurectec-wilmington CA County: Los Angeles	County
06042002109 SWF	Ever Wear Tire Co CA County: Los Angeles	County
06042002105 SWF	Fargo Tire & Rubber Company, Inc. CA County: Los Angeles	County
06042002117 SWF	Foothill Waste Tire Pile CA County: Los Angeles	County
06042002142 SWF	H And R Tire - Allen Tire Company CA County: Los Angeles	County
06042002107 SWF	Hall Waste Tire Site CA County: Los Angeles	County
06042002112 SWF	Jack's Recycling CA County: Los Angeles	County
06042002134 SWF	Jimenez Tire Sales CA County: Los Angeles	County
06042002119 SWF	Johnny's Tires Inc. CA County: Los Angeles	County
06042002102 SWF	Lakin Tire Of California, Inc. CA County: Los Angeles	County
06042002110 SWF	Lankershim Waste Tire Pile CA County: Los Angeles	County
06042002131 SWF	Los Angeles Tire House Inc. CA County: Los Angeles	County
06042002144 SWF	Los Tres Amigos Tire Service CA County: Los Angeles	County
06042002138 SWF	Mark Cannon CA County: Los Angeles	County

ERIS ID. DATABASE	FACILITY ADDRESS COMMENTS	SELECTED BY
06042002113 SWF	Mike's Tireman Inc CA County: Los Angeles	County
06042002114 SWF	Pacoima Waste Tire Site CA County: Los Angeles	County
06042002115 SWF	Parco Recycling Of California CA County: Los Angeles	County
06042002135 SWF	Scher Tire-goodyear Tire Ctr CA County: Los Angeles	County
06042002111 SWF	T.y.r.e.s. Inc CA County: Los Angeles	County
06042002103 SWF	Texaco Inc. Montebelo Research Laborator CA County: Los Angeles	County
06042002123 SWF	Tire Pro CA County: Los Angeles	County
06042002124 SWF	Used Tire King CA County: Los Angeles	County
06042002122 SWF	Village Tire Service CA County: Los Angeles	County
06042002151 SWF	Waste Not Enterprises CA County: Los Angeles	County
06042002108 SWF	Waste Tire Corp CA County: Los Angeles	County
06042002083 SWF	Athens Disposal Company Mrf 14048 E. Valley Blvd CA County: Los Angeles	County
06042002094 SWF	L.a. County Flood Control District 6502 E Pch/6655 Marina Drive CA County: Los Angeles	County
06042002087 SWF	San Clemente Island Landfill Naval Auxiliary Landing Field CA County: Los Angeles	County

ERIIS ID. DATABASE	FACILITY ADDRESS COMMENTS	SELECTED BY
06042002077 SWF	Us Navy Landfill San Clemente Island Central CA County: Los Angeles	County

CALIFORNIA UNDERGROUND STORAGE TANKS  
RST - UNPLOTTABLE SITES

ERIIS Report #109199A

Aug 30, 1996

ERIIS ID	FACILITY	ADDRESS
06010000263	3m Pharmaceuticals /c	19901 Nordhoff St Northridge, CA 91324-3213 COUNTY: Los Angeles

BUSINESS DESCRIPTION: Pharamceuticals

MANAGER: G D Scott (818) 341-1300

OWNER TANK ID: Not Reported	TANK DESCRIPTION: Single Wall
CAPACITY: 10000 G	TANK MATERIAL: Bare Steel
STATUS: Active	SUBSTANCE: Chemical Product
OWNER TANK ID: Not Reported	TANK DESCRIPTION: Single Wall
CAPACITY: 10000 G	TANK MATERIAL: Bare Steel
STATUS: Removed	SUBSTANCE: Chemical Product
OWNER TANK ID: Not Reported	TANK DESCRIPTION: Single Wall
CAPACITY: 10000 G	TANK MATERIAL: Bare Steel
STATUS: Removed	SUBSTANCE: Not Reported
OWNER TANK ID: Not Reported	TANK DESCRIPTION: Single Wall With Exterior Liner
CAPACITY: 10000 G	TANK MATERIAL: Bare Steel
STATUS: Removed	SUBSTANCE: Chemical Product
OWNER TANK ID: Not Reported	TANK DESCRIPTION: Single Wall
CAPACITY: 4000 G	TANK MATERIAL: Stainless Steel
STATUS: Removed	SUBSTANCE: Regular Unleaded
OWNER TANK ID: Not Reported	TANK DESCRIPTION: Single Wall
CAPACITY: 4000 G	TANK MATERIAL: Stainless Steel
STATUS: Removed	SUBSTANCE: Chemical Product
OWNER TANK ID: Not Reported	TANK DESCRIPTION: Single Wall
CAPACITY: 10000 G	TANK MATERIAL: Bare Steel
STATUS: Removed	SUBSTANCE: Chemical Product
OWNER TANK ID: Not Reported	TANK DESCRIPTION: Single Wall
CAPACITY: 10000 G	TANK MATERIAL: Bare Steel
STATUS: Removed	SUBSTANCE: Chemical Product
OWNER TANK ID: Not Reported	TANK DESCRIPTION: Single Wall
CAPACITY: 10000 G	TANK MATERIAL: Bare Steel
STATUS: Removed	SUBSTANCE: Chemical Product
OWNER TANK ID: Not Reported	TANK DESCRIPTION: Single Wall
CAPACITY: 10000 G	TANK MATERIAL: Bare Steel
STATUS: Removed	SUBSTANCE: Not Reported
OWNER TANK ID: Not Reported	TANK DESCRIPTION: Single Wall
CAPACITY: 10000 G	TANK MATERIAL: Bare Steel
STATUS: Removed	SUBSTANCE: Not Reported
OWNER TANK ID: Not Reported	TANK DESCRIPTION: Single Wall
CAPACITY: 2000 G	TANK MATERIAL: Bare Steel
STATUS: Removed	SUBSTANCE: Regular Unleaded
OWNER TANK ID: Not Reported	TANK DESCRIPTION: Single Wall
CAPACITY: 3000 G	TANK MATERIAL: Bare Steel
STATUS: Removed	SUBSTANCE: Regular Unleaded

06010002857	Amphibians West	7450 Hayvenhurst Van Nuys, CA 91324 COUNTY: Los Angeles
-------------	-----------------	---------------------------------------------------------------

BUSINESS DESCRIPTION: Jet Fuel Farm

MANAGER: Jeff Minnebraker (818) 908-9574

OWNER TANK ID: Not Reported	TANK DESCRIPTION: Not Reported
CAPACITY: 0	TANK MATERIAL: Not Reported
STATUS: Not Reported	SUBSTANCE: Not Reported

06010020858	Fire Station #28	11641 Corbin Los Angeles, CA 91324 COUNTY: Los Angeles
-------------	------------------	--------------------------------------------------------------

BUSINESS DESCRIPTION: Gen Undergrnd Tank

MANAGER: Captain On Duty (818) 960-3995

OWNER TANK ID: Not Reported	TANK DESCRIPTION: Not Reported
CAPACITY: 0	TANK MATERIAL: Not Reported
STATUS: Not Reported	SUBSTANCE: Not Reported



CALIFORNIA SOLID WASTE INFORMATION SYSTEM  
SWF - UNPLOTTABLE SITES

ERIIS Report #109199A

Aug 30, 1996

ERIIS ID SWIS ID	FACILITY	ADDRESS
06042002077 19-AA-0063	Us Navy Landfill	San Clemente Island Central CA COUNTY: Los Angeles
OWNER:	Us Navy - North Island Nas Code 18 P.o. Box 357040 San Diego, CA 92135	OWNER CONTACT: (619) 545-1125
CLASSIFICATION:		REGULATORY STATUS: Permitted
CATEGORY:		OPERATIONAL STATUS: Active
ACTIVITY:	Solid Waste Landfill	
06042002083 19-AA-0863	Athens Disposal Company Mrf	14048 E. Valley Blvd CA COUNTY: Los Angeles
OWNER:		OWNER CONTACT:
CLASSIFICATION:		REGULATORY STATUS: To Be
CATEGORY:		OPERATIONAL STATUS: Active
ACTIVITY:	Materials Recovery	
06042002087 19-AA-0896	San Clemente Island Landfill	Naval Auxiliary Landing Field CA COUNTY: Los Angeles
OWNER:		OWNER CONTACT:
CLASSIFICATION:		REGULATORY STATUS: Proposed
CATEGORY:		OPERATIONAL STATUS: Closing
ACTIVITY:	Solid Waste Disposal Site	
06042002094 19-AK-5025	L.a. County Flood Control District	6502 E Pch/6655 Marina Drive CA COUNTY: Los Angeles
OWNER:		OWNER CONTACT:
CLASSIFICATION:		REGULATORY STATUS: To Be
CATEGORY:		OPERATIONAL STATUS: Active
ACTIVITY:	Solid Waste Landfill	
06042002102 19-TI-0014	Lakin Tire Of California, Inc.	CA COUNTY: Los Angeles
OWNER:		OWNER CONTACT:
CLASSIFICATION:		REGULATORY STATUS: To Be
CATEGORY:		OPERATIONAL STATUS: To Be
ACTIVITY:	Waste Tire Location	
06042002103 19-TI-0024	Texaco Inc. Montebelo Research Laborator	CA COUNTY: Los Angeles
OWNER:		OWNER CONTACT:
CLASSIFICATION:		REGULATORY STATUS: To Be
CATEGORY:		OPERATIONAL STATUS: To Be
ACTIVITY:	Waste Tire Location	

ERIIS ENVIRONMENTAL DATA REPORT  
CALIFORNIA SOLID WASTE INFORMATION SYSTEM  
SWF - UNPLOTTABLE SITES

ERIIS Report #109199A

Aug 30, 1996

---

ERIIS ID SWIS ID	FACILITY	ADDRESS
06042002104 19-TI-0032	Eurectec-wilmington	CA COUNTY: Los Angeles
OWNER:		OWNER CONTACT:
CLASSIFICATION:		REGULATORY STATUS: To Be
CATEGORY:		OPERATIONAL STATUS: To Be
ACTIVITY: Waste Tire Location		
<hr/>		
06042002105 19-TI-0046	Fargo Tire & Rubber Company, Inc.	CA COUNTY: Los Angeles
OWNER:		OWNER CONTACT:
CLASSIFICATION:		REGULATORY STATUS: To Be
CATEGORY:		OPERATIONAL STATUS: To Be
ACTIVITY: Waste Tire Location		
<hr/>		
06042002106 19-TI-0053	Daniels Tire Service	CA COUNTY: Los Angeles
OWNER:		OWNER CONTACT:
CLASSIFICATION:		REGULATORY STATUS: To Be
CATEGORY:		OPERATIONAL STATUS: To Be
ACTIVITY: Waste Tire Location		
<hr/>		
06042002107 19-TI-0055	Hall Waste Tire Site	CA COUNTY: Los Angeles
OWNER:		OWNER CONTACT:
CLASSIFICATION:		REGULATORY STATUS: To Be
CATEGORY:		OPERATIONAL STATUS: To Be
ACTIVITY: Waste Tire Location		
<hr/>		
06042002108 19-TI-0092	Waste Tire Corp	CA COUNTY: Los Angeles
OWNER:		OWNER CONTACT:
CLASSIFICATION:		REGULATORY STATUS: To Be
CATEGORY:		OPERATIONAL STATUS: To Be
ACTIVITY: Waste Tire Location		
<hr/>		
06042002109 19-TI-0101	Ever Wear Tire Co	CA COUNTY: Los Angeles
OWNER:		OWNER CONTACT:
CLASSIFICATION:		REGULATORY STATUS: To Be
CATEGORY:		OPERATIONAL STATUS: To Be
ACTIVITY: Waste Tire Location		

---

ERIIS ENVIRONMENTAL DATA SYSTEM  
CALIFORNIA SOLID WASTE INFORMATION SYSTEM  
SWP - UNPLOTTABLE SITES

ERIIS Report #109199A

Aug 30, 1991

ERIIS ID SWIS ID	FACILITY	ADDRESS
06042002110 19-TI-0105	Lankershim Waste Tire Pile	CA COUNTY: Los Angeles
OWNER:		OWNER CONTACT:
CLASSIFICATION:		REGULATORY STATUS: To Be
CATEGORY:		OPERATIONAL STATUS: To Be
ACTIVITY: Waste Tire Location		
06042002111 19-TI-0117	T.y.r.e.s. Inc	CA COUNTY: Los Angeles
OWNER:		OWNER CONTACT:
CLASSIFICATION:		REGULATORY STATUS: To Be
CATEGORY:		OPERATIONAL STATUS: To Be
ACTIVITY: Waste Tire Location		
06042002112 19-TI-0122	Jack's Recycling	CA COUNTY: Los Angeles
OWNER:		OWNER CONTACT:
CLASSIFICATION:		REGULATORY STATUS: To Be
CATEGORY:		OPERATIONAL STATUS: To Be
ACTIVITY: Waste Tire Location		
06042002113 19-TI-0138	Mike's Tireman Inc	CA COUNTY: Los Angeles
OWNER:		OWNER CONTACT:
CLASSIFICATION:		REGULATORY STATUS: To Be
CATEGORY:		OPERATIONAL STATUS: To Be
ACTIVITY: Waste Tire Location		
06042002114 19-TI-0140	Pacoima Waste Tire Site	CA COUNTY: Los Angeles
OWNER:		OWNER CONTACT:
CLASSIFICATION:		REGULATORY STATUS: To Be
CATEGORY:		OPERATIONAL STATUS: To Be
ACTIVITY: Waste Tire Location		
06042002115 19-TI-0152	Parco Recycling Of California	CA COUNTY: Los Angeles
OWNER:		OWNER CONTACT:
CLASSIFICATION:		REGULATORY STATUS: To Be
CATEGORY:		OPERATIONAL STATUS: To Be
ACTIVITY: Waste Tire Location		

ENVIRONMENTAL INFORMATION SYSTEM  
CALIFORNIA SOLID WASTE INFORMATION SYSTEM  
SWP - UNPLOTTABLE SITES

Aug 30, 1996

ERIIS Report #109199A

ERIIS ID SWIS ID	FACILITY	ADDRESS
06042002116 19-TI-0162	Chase Tires	CA COUNTY: Los Angeles
OWNER:		OWNER CONTACT:
CLASSIFICATION:		REGULATORY STATUS: To Be
CATEGORY:		OPERATIONAL STATUS: To Be
ACTIVITY: Waste Tire Location		
06042002117 19-TI-0164	Foothill Waste Tire Pile	CA COUNTY: Los Angeles
OWNER:		OWNER CONTACT:
CLASSIFICATION:		REGULATORY STATUS: To Be
CATEGORY:		OPERATIONAL STATUS: To Be
ACTIVITY: Waste Tire Location		
06042002118 19-TI-0179	Drexler Tires & Rubber Co.	CA COUNTY: Los Angeles
OWNER:		OWNER CONTACT:
CLASSIFICATION:		REGULATORY STATUS: To Be
CATEGORY:		OPERATIONAL STATUS: To Be
ACTIVITY: Waste Tire Location		
06042002119 19-TI-0189	Johnny's Tires Inc.	CA COUNTY: Los Angeles
OWNER:		OWNER CONTACT:
CLASSIFICATION:		REGULATORY STATUS: To Be
CATEGORY:		OPERATIONAL STATUS: To Be
ACTIVITY: Waste Tire Location		
06042002120 19-TI-0190	Drive Service	CA COUNTY: Los Angeles
OWNER:		OWNER CONTACT:
CLASSIFICATION:		REGULATORY STATUS: To Be
CATEGORY:		OPERATIONAL STATUS: To Be
ACTIVITY: Waste Tire Location		
06042002121 19-TI-0197	Caldwell Tire, Inc.	CA COUNTY: Los Angeles
OWNER:		OWNER CONTACT:
CLASSIFICATION:		REGULATORY STATUS: To Be
CATEGORY:		OPERATIONAL STATUS: To Be
ACTIVITY: Waste Tire Location		

ERIS ENVIRONMENTAL DATA REPORT  
CALIFORNIA SOLID WASTE INFORMATION SYSTEM  
SWF - UNPLOTTABLE SITES

ERIIS Report #109199A

Aug 30, 1996

---

ERIIS ID SWIS ID	FACILITY	ADDRESS
06042002122 19-TI-0201	Village Tire Service	CA COUNTY: Los Angeles
OWNER:		OWNER CONTACT:
CLASSIFICATION:		REGULATORY STATUS: To Be
CATEGORY:		OPERATIONAL STATUS: To Be
ACTIVITY: Waste Tire Location		
<hr/>		
06042002123 19-TI-0209	Tire Pro	CA COUNTY: Los Angeles
OWNER:		OWNER CONTACT:
CLASSIFICATION:		REGULATORY STATUS: To Be
CATEGORY:		OPERATIONAL STATUS: To Be
ACTIVITY: Waste Tire Location		
<hr/>		
06042002124 19-TI-0213	Used Tire King	CA COUNTY: Los Angeles
OWNER:		OWNER CONTACT:
CLASSIFICATION:		REGULATORY STATUS: To Be
CATEGORY:		OPERATIONAL STATUS: To Be
ACTIVITY: Waste Tire Location		
<hr/>		
06042002125 19-TI-0214	Daniel's Tires	CA COUNTY: Los Angeles
OWNER:		OWNER CONTACT:
CLASSIFICATION:		REGULATORY STATUS: To Be
CATEGORY:		OPERATIONAL STATUS: To Be
ACTIVITY: Waste Tire Location		
<hr/>		
06042002126 19-TI-0215	Apollo Tires	CA COUNTY: Los Angeles
OWNER:		OWNER CONTACT:
CLASSIFICATION:		REGULATORY STATUS: To Be
CATEGORY:		OPERATIONAL STATUS: To Be
ACTIVITY: Waste Tire Location		
<hr/>		
06042002127 19-TI-0216	Armando Auto Service	CA COUNTY: Los Angeles
OWNER:		OWNER CONTACT:
CLASSIFICATION:		REGULATORY STATUS: To Be
CATEGORY:		OPERATIONAL STATUS: To Be
ACTIVITY: Waste Tire Location		

---

ERIIS ENVIRONMENTAL DATA REPORT  
CALIFORNIA SOLID WASTE INFORMATION SYSTEM  
SWF - UNPLOTTABLE SITES

ERIIS Report #109199A

Aug 30, 1996

ERIIS ID SWIS ID	FACILITY	ADDRESS
06042002128 19-TI-0217	Art Tire Co.	CA COUNTY: Los Angeles
OWNER:		OWNER CONTACT:
CLASSIFICATION:		REGULATORY STATUS: To Be
CATEGORY:		OPERATIONAL STATUS: To Be
ACTIVITY: Waste Tire Location		
06042002129 19-TI-0218	Cicer's Tire	CA COUNTY: Los Angeles
OWNER:		OWNER CONTACT:
CLASSIFICATION:		REGULATORY STATUS: To Be
CATEGORY:		OPERATIONAL STATUS: To Be
ACTIVITY: Waste Tire Location		
06042002130 19-TI-0250	City Tireco	CA COUNTY: Los Angeles
OWNER:		OWNER CONTACT:
CLASSIFICATION:		REGULATORY STATUS: To Be
CATEGORY:		OPERATIONAL STATUS: To Be
ACTIVITY: Waste Tire Location		
06042002131 19-TI-0251	Los Angeles Tire House Inc.	CA COUNTY: Los Angeles
OWNER:		OWNER CONTACT:
CLASSIFICATION:		REGULATORY STATUS: To Be
CATEGORY:		OPERATIONAL STATUS: To Be
ACTIVITY: Waste Tire Location		
06042002132 19-TI-0291	A-auto	CA COUNTY: Los Angeles
OWNER:		OWNER CONTACT:
CLASSIFICATION:		REGULATORY STATUS: To Be
CATEGORY:		OPERATIONAL STATUS: To Be
ACTIVITY: Waste Tire Location		
06042002133 19-TI-0292	B & D Auto Wrecking	CA COUNTY: Los Angeles
OWNER:		OWNER CONTACT:
CLASSIFICATION:		REGULATORY STATUS: To Be
CATEGORY:		OPERATIONAL STATUS: To Be
ACTIVITY: Waste Tire Location		

ERIIS ENVIRONMENTAL DATA SYSTEM  
CALIFORNIA SOLID WASTE INFORMATION SYSTEM  
SWF - UNPLOTTABLE SITES

ERIIS Report #109199A

Aug 30, 1996

---

ERIIS ID SWIS ID	FACILITY	ADDRESS
06042002134 19-TI-0300	Jimenez Tire Sales	CA COUNTY: Los Angeles
OWNER:		OWNER CONTACT:
CLASSIFICATION: CATEGORY: ACTIVITY: Waste Tire Location		REGULATORY STATUS: To Be OPERATIONAL STATUS: To Be
06042002135 19-TI-0307	Scher Tire-goodyear Tire Ctr	CA COUNTY: Los Angeles
OWNER:		OWNER CONTACT:
CLASSIFICATION: CATEGORY: ACTIVITY: Waste Tire Location		REGULATORY STATUS: To Be OPERATIONAL STATUS: To Be
06042002136 19-TI-0330	Enrique Tovar's Tire Site	CA COUNTY: Los Angeles
OWNER:		OWNER CONTACT:
CLASSIFICATION: CATEGORY: ACTIVITY: Waste Tire Location		REGULATORY STATUS: To Be OPERATIONAL STATUS: To Be
06042002137 19-TI-0331	Daniels Tire Service	CA COUNTY: Los Angeles
OWNER:		OWNER CONTACT:
CLASSIFICATION: CATEGORY: ACTIVITY: Waste Tire Location		REGULATORY STATUS: To Be OPERATIONAL STATUS: To Be
06042002138 19-TI-0332	Mark Cannon	CA COUNTY: Los Angeles
OWNER:		OWNER CONTACT:
CLASSIFICATION: CATEGORY: ACTIVITY: Waste Tire Location		REGULATORY STATUS: To Be OPERATIONAL STATUS: To Be
06042002139 19-TI-0333	Checker Tire & Wheel	CA COUNTY: Los Angeles
OWNER:		OWNER CONTACT:
CLASSIFICATION: CATEGORY: ACTIVITY: Waste Tire Location		REGULATORY STATUS: To Be OPERATIONAL STATUS: To Be

---

CALIFORNIA SOLID WASTE INFORMATION SYSTEM  
SWP - UNPLOTTABLE SITES

ERIIS Report #109199A

Aug 30, 1996

---

ERIIS ID SWIS ID	FACILITY	ADDRESS
06042002140 19-TI-0387	Capro International	CA COUNTY: Los Angeles
OWNER:		OWNER CONTACT:
CLASSIFICATION: CATEGORY: ACTIVITY: Waste Tire Location		REGULATORY STATUS: To Be OPERATIONAL STATUS: To Be
<hr/>		
06042002141 19-TI-0409		CA COUNTY: Los Angeles
OWNER:		OWNER CONTACT:
CLASSIFICATION: CATEGORY: ACTIVITY: Waste Tire Location		REGULATORY STATUS: To Be OPERATIONAL STATUS: To Be
<hr/>		
06042002142 19-TI-0411	H And R Tire - Allen Tire Company	CA COUNTY: Los Angeles
OWNER:		OWNER CONTACT:
CLASSIFICATION: CATEGORY: ACTIVITY: Waste Tire Location		REGULATORY STATUS: To Be OPERATIONAL STATUS: To Be
<hr/>		
06042002143 19-TI-0413	Ecology Auto Wrecking Inc.	CA COUNTY: Los Angeles
OWNER:		OWNER CONTACT:
CLASSIFICATION: CATEGORY: ACTIVITY: Waste Tire Location		REGULATORY STATUS: To Be OPERATIONAL STATUS: To Be
<hr/>		
06042002144 19-TI-0418	Los Tres Amigos Tire Service	CA COUNTY: Los Angeles
OWNER:		OWNER CONTACT:
CLASSIFICATION: CATEGORY: ACTIVITY: Waste Tire Location		REGULATORY STATUS: To Be OPERATIONAL STATUS: To Be
<hr/>		
06042002145 19-TI-0422		CA COUNTY: Los Angeles
OWNER:		OWNER CONTACT:
CLASSIFICATION: CATEGORY: ACTIVITY: Waste Tire Location		REGULATORY STATUS: To Be OPERATIONAL STATUS: To Be

---



CALIFORNIA SOLID WASTE INFORMATION SYSTEM  
SWP - UNPLOTTABLE SITES

ERIIS Report #109199A

Aug 30, 1996

---

ERIIS ID SWIS ID	FACILITY	ADDRESS
---------------------	----------	---------

---

06042002146 19-TI-0424	American Tire Collection Inc.	CA COUNTY: Los Angeles
OWNER:		OWNER CONTACT:
CLASSIFICATION:		REGULATORY STATUS: To Be
CATEGORY:		OPERATIONAL STATUS: To Be
ACTIVITY: Waste Tire Location		

---

06042002147 19-TI-0442	A & J Tires	CA COUNTY: Los Angeles
OWNER:		OWNER CONTACT:
CLASSIFICATION:		REGULATORY STATUS: To Be
CATEGORY:		OPERATIONAL STATUS: To Be
ACTIVITY: Waste Tire Location		

---

06042002148 19-TI-0443	A & J Tires	CA COUNTY: Los Angeles
OWNER:		OWNER CONTACT:
CLASSIFICATION:		REGULATORY STATUS: To Be
CATEGORY:		OPERATIONAL STATUS: To Be
ACTIVITY: Waste Tire Location		

---

06042002149 19-TI-0444	Airport Tires	CA COUNTY: Los Angeles
OWNER:		OWNER CONTACT:
CLASSIFICATION:		REGULATORY STATUS: To Be
CATEGORY:		OPERATIONAL STATUS: To Be
ACTIVITY: Waste Tire Location		

---

06042002150 19-TI-0449	21st Century Recycling Center	CA COUNTY: Los Angeles
OWNER:		OWNER CONTACT:
CLASSIFICATION:		REGULATORY STATUS: To Be
CATEGORY:		OPERATIONAL STATUS: To Be
ACTIVITY: Waste Tire Location		

---

06042002151 19-TI-0453	Waste Not Enterprises	CA COUNTY: Los Angeles
OWNER:		OWNER CONTACT:
CLASSIFICATION:		REGULATORY STATUS: To Be
CATEGORY:		OPERATIONAL STATUS: To Be
ACTIVITY: Waste Tire Location		

---



505 Hunter Park Dr, Suite 200  
 Herndon, VA 22070  
 (703)634-0600 (800)969-0402  
 FAX: (703)634-0606

**SITE INFORMATION**

19601 Nordhoff Street  
 Northridge, CA  
 Los Angeles County  
 Job Number: 109199A  
 Map Plotted: Aug 30, 1996

**MAP LEGEND**

- Site
- Radii 1/4, 1/2, 1 Mi
- Hydrography
- Railroads
- Roads
- ★ NPL 0 Sites
- RCRI\_TS 0 Sites
- CERCLIS 0 Sites
- NFRAP 1 Site
- RCRI\_LG 0 Sites
- RCRI\_SG 1 Site
- ☆ ERNS 0 Sites
- HWS 11 Sites
- ⊕ LRST 8 Sites
- △ SWF 0 Sites
- ◇ RST 2 Sites
- Ⓐ OGW 0 Sites

Miles



The information on this map is subject to the ERIS Disclaimer.  
 Copyright 1996 ERIS, Inc.

